

'CENTOR' BI- FOLD DOORSET



Heron Joinery[®]

Crafting Beauty & Warmth

Through innovative design and full height glazing , Bi Folding doors bring the outside, inside, whilst enhancing the flow of natural light entering the home with a clear 90% unobstructed view, as the door leafs fold back on each other. The Centor Bifold doorset will give low level access and is Part M compliant.

Manufactured from selective timbers compliant with the classification requirements of BS 942 and from certified sustainable sources, additional prominent features and attributes include:

- Individual door sections preservative treated prior to assembly
- Anti warp profile section design
- Suitability for openings up to 16 metres wide
- Variable positioning of master locking door
- Secure locking system
- Glazing configurations in compliance with BS 6262-4
- Low level access, Part M Compliant.
- Fully weather sealed
- Hardware corrosive compliance with BS EN 1670
- Hardwood cill as standard
- Available in a range of high performance, durable stains or paint finishes to agreed customer specification

Bi-folding doors are available in a variety of combinations with options for locating the opening access sash, with up to 8 folding sashes in a frame. Alternately access can be gained via the folding sashes.

The Bi-folding door is ideal for new build and home extensions, including conservatories. Whilst providing a popular choice for the replacement of existing timber, plastic or aluminium French and Patios doors.



Centor Bifold Doorset	Door
Min Door Height	1770
Max Door Height	3000
Max Door Width	1000
Min Door Width	500
Max Frame Width	16metres
Max No of Sashes Per Frame	16 (8 in each direction)
Max Sash Weight	80kg

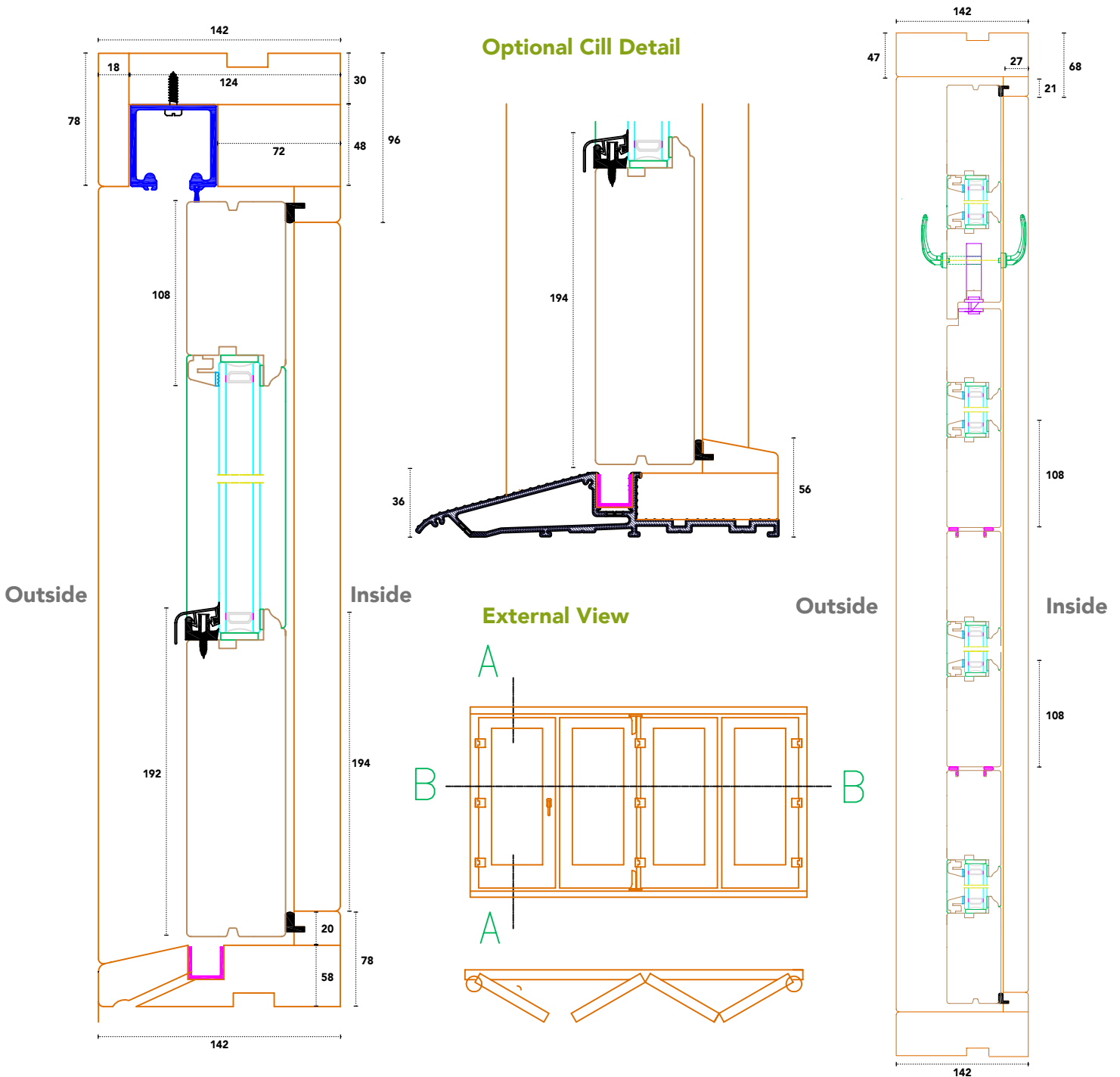

Heron Joinery has been crafting timber windows and doors for over 60 years

- 14 Different Window and Door Types
- U Values from 0.7
- Choice of Colours
- Single, Double and Triple Glazed Options
- 30 Year Timber Warranty
- Secure by Design Certified

www.heronjoinery.com

58mm Open Out Inline Bifold

68 x 142mm Frame Cill,
56 x 142 Frame Jambs &
96 x 142 Frame Jambs.

108 x 58 Door Stiles & head,
194 x 58mm Bottom Rail.

24mm Double Glazed Units.

28 D/G or 36mm Triple Glazing is available, however framing thickness changes to 68mm from 58mm, all width dimensions stay the same.

Standard glazing specification is Aluminium bottom bead with timber beads to sides and head.

Timber Drained Bottom Block is also available.

Bifold Gear is available in 4 finished. Polished Stainless, Brushed Satin, black and Titanium Gold.

Contact

heronjoinery@heronjoinery.com

028 7962 7277



Heron Joinery[®]

Crafting Beauty & Warmth